

# XB10 10 & 15 joule xenon beacon range

Ex d(e), weatherproof



## Overview

These compact and lightweight 10 & 15 Joule beacons have been designed for use in potentially explosive atmospheres and harsh environmental conditions. The beacon housing, including the flamepaths, is manufactured completely from a UV stable glass reinforced polyester which is ideally suited for use offshore and onshore. Stainless steel screws and mounting bracket are incorporated ensuring a totally corrosion free unit. An additional body clamp is available for high-vibration environments. Units can be painted to customer specification and supplied with identification labels.

## Features

- Zone 1 and Zone 2 use
- Ex d(e) IIB T4
- ATEX approved, Ex II 2G
- IECEx certified Gb
- TR CU certified
- Brazilian (INMETRO) certified
- IP66 and IP67
- Certified temperature -55°C to +55°C\*
- Low current 10 Joule version available
- Corrosion Free GRP
- Various lens colours
- Lens guard fitted as standard
- Stainless steel mounting bracket & screws
- Replaceable twin tubes
- Optional telephone initiate
- Optional earth continuity

\*Model dependent



## Certifications

<b>ATEX Ex d</b>	Cert. no. Baseefa 04ATEX2204X Certified to: EN60079-0, EN60079-1 Ex II 2G, Ex d IIB T4 Gb
<b>ATEX Ex de</b>	Cert. no. Baseefa 04ATEX2226X Certified to: EN60079-0, EN60079-1, EN60079-7 Ex II 2G, Ex de IIB T4 Gb
<b>IECEX Ex d</b>	Cert. no. IECEX BAS 10.0086X Certified to: IEC60079-0, IEC60079-1 Ex d IIB T4 Gb
<b>IECEX Ex de</b>	Cert. no. IECEX BAS 10.0087X Certified to: IEC60079-0, IEC60079-1, IEC60079-7 Ex de IIB T4 Gb
<b>TR CU Ex d</b>	1Ex d IIB T4 Gb. Russian Fire Alarm approved
<b>TR CU Ex de</b>	1Ex de IIB T4 Gb. Russian Fire Alarm approved
<b>INMETRO Ex d</b>	Ex d IIB T4 Gb

## Specifications

<b>Material</b>	Body: glass reinforced polyester Lens: glass Cover screws + bracket: stainless steel 316
<b>Finish</b>	Natural black or painted to customer specification
<b>Weight</b>	Ex d 2.8kg. Ex de 3.6kg
<b>Certified temp</b>	15J unit: Exd -55°C to +50°C Exde -50°C to +50°C 10J unit: Exd -55°C to +65°C Exde -50°C to +65°C
<b>Ingress protection</b>	IP66 & IP67
<b>Fire retardancy</b>	GRP is fire retardant to ISO 1210
<b>Terminals</b>	4 x 2.5mm <sup>2</sup> (dc), 6 x 2.5mm <sup>2</sup> (ac)
<b>Mounting</b>	Wall mounted via bracket
<b>Tube life</b>	>1x10 <sup>6</sup> flashes

### Electrical ratings:

Voltage	dc				ac			
	24	48	110	220/240/254	110	220/240/254	110	220/240/254
Tube energy (J)	10	15	10	15	10	15	10	15
Current (mA)	700	1200	300	560	190	300	100	145
Effective intensity (Cd)	285	330	285	330	285	330	285	330
Peak intensity (Cd)	74179	111269	74179	111269	74179	111269	74179	111269
Power consumption (W)	16.8	28.8	14.4	26.8	20.9	33	24	34.8
Flash rate	1Hz (other flash rates available on request, please specify)							

Note: The above figures (Cd) are for a clear lens @ 1Hz flash rate

## Ordering requirements

The following code is designed to help in selection of the correct unit. Build up the reference number by inserting the code for each component into the appropriate box

Model	Certification	Voltage	Power	Lens colour	Tag/duty	Options	Entries	Finish																																																																																																				
<b>XB10</b>																																																																																																												
	<table border="1"> <thead> <tr> <th>Certification</th> <th>Code</th> </tr> </thead> <tbody> <tr><td>Uncertified</td><td>W</td></tr> <tr><td>Ex d</td><td>D</td></tr> <tr><td>Ex de</td><td>E</td></tr> <tr><td>IECEX Ex d</td><td>DJ</td></tr> <tr><td>IECEX Ex de</td><td>EJ</td></tr> <tr><td>TR CU Ex d</td><td>DG*</td></tr> <tr><td>TR CU Ex de</td><td>EG*</td></tr> <tr><td>INMETRO Ex d</td><td>DM</td></tr> </tbody> </table> <p>* Russian Fire approved as standard</p>	Certification	Code	Uncertified	W	Ex d	D	Ex de	E	IECEX Ex d	DJ	IECEX Ex de	EJ	TR CU Ex d	DG*	TR CU Ex de	EG*	INMETRO Ex d	DM	<table border="1"> <thead> <tr> <th>Voltage</th> <th>Code</th> </tr> </thead> <tbody> <tr><td>24Vdc</td><td>024</td></tr> <tr><td>48Vdc</td><td>048</td></tr> <tr><td>110Vac</td><td>110</td></tr> <tr><td>220Vac</td><td>220</td></tr> <tr><td>240Vac</td><td>240</td></tr> <tr><td>254Vac</td><td>254</td></tr> </tbody> </table>	Voltage	Code	24Vdc	024	48Vdc	048	110Vac	110	220Vac	220	240Vac	240	254Vac	254	<table border="1"> <thead> <tr> <th>Power</th> <th>Code</th> </tr> </thead> <tbody> <tr><td>10J</td><td>T</td></tr> <tr><td>15J</td><td>F</td></tr> </tbody> </table>	Power	Code	10J	T	15J	F	<table border="1"> <thead> <tr> <th>Lens colour</th> <th>Code</th> </tr> </thead> <tbody> <tr><td>Red</td><td>R</td></tr> <tr><td>Blue</td><td>B</td></tr> <tr><td>Green</td><td>G</td></tr> <tr><td>Amber</td><td>A</td></tr> <tr><td>Yellow</td><td>Y</td></tr> <tr><td>Clear</td><td>C</td></tr> </tbody> </table>	Lens colour	Code	Red	R	Blue	B	Green	G	Amber	A	Yellow	Y	Clear	C	<table border="1"> <thead> <tr> <th>Label</th> <th>Code</th> </tr> </thead> <tbody> <tr><td>None</td><td>N</td></tr> <tr><td>Yes</td><td>Y*</td></tr> </tbody> </table> <p>* Please specify</p>	Label	Code	None	N	Yes	Y*	<table border="1"> <thead> <tr> <th>Option</th> <th>Code</th> </tr> </thead> <tbody> <tr><td>None</td><td>N</td></tr> <tr><td>Telephone initiate</td><td>T</td></tr> <tr><td>Earth continuity</td><td>E</td></tr> <tr><td>3m cable tail</td><td>G</td></tr> </tbody> </table>	Option	Code	None	N	Telephone initiate	T	Earth continuity	E	3m cable tail	G	<table border="1"> <thead> <tr> <th>Entries</th> <th>Code</th> </tr> </thead> <tbody> <tr><td><b>Ex d</b></td><td></td></tr> <tr><td>1 x M20</td><td>1B</td></tr> <tr><td>1 x PG13.5</td><td>1P</td></tr> <tr><td>2 x M20</td><td>2B</td></tr> <tr><td>2 x PG13.5</td><td>2P</td></tr> <tr><td><b>Ex de</b></td><td></td></tr> <tr><td>3 x M20</td><td>3B</td></tr> </tbody> </table>	Entries	Code	<b>Ex d</b>		1 x M20	1B	1 x PG13.5	1P	2 x M20	2B	2 x PG13.5	2P	<b>Ex de</b>		3 x M20	3B	<table border="1"> <thead> <tr> <th>Finish</th> <th>Code</th> </tr> </thead> <tbody> <tr><td>Natural black</td><td>N</td></tr> <tr><td>Red</td><td>R</td></tr> <tr><td>Blue</td><td>B</td></tr> <tr><td>Yellow</td><td>Y</td></tr> <tr><td>Grey</td><td>G</td></tr> <tr><td>White</td><td>W</td></tr> <tr><td>Special</td><td>S*</td></tr> </tbody> </table> <p>* Please specify</p>	Finish	Code	Natural black	N	Red	R	Blue	B	Yellow	Y	Grey	G	White	W	Special	S*
Certification	Code																																																																																																											
Uncertified	W																																																																																																											
Ex d	D																																																																																																											
Ex de	E																																																																																																											
IECEX Ex d	DJ																																																																																																											
IECEX Ex de	EJ																																																																																																											
TR CU Ex d	DG*																																																																																																											
TR CU Ex de	EG*																																																																																																											
INMETRO Ex d	DM																																																																																																											
Voltage	Code																																																																																																											
24Vdc	024																																																																																																											
48Vdc	048																																																																																																											
110Vac	110																																																																																																											
220Vac	220																																																																																																											
240Vac	240																																																																																																											
254Vac	254																																																																																																											
Power	Code																																																																																																											
10J	T																																																																																																											
15J	F																																																																																																											
Lens colour	Code																																																																																																											
Red	R																																																																																																											
Blue	B																																																																																																											
Green	G																																																																																																											
Amber	A																																																																																																											
Yellow	Y																																																																																																											
Clear	C																																																																																																											
Label	Code																																																																																																											
None	N																																																																																																											
Yes	Y*																																																																																																											
Option	Code																																																																																																											
None	N																																																																																																											
Telephone initiate	T																																																																																																											
Earth continuity	E																																																																																																											
3m cable tail	G																																																																																																											
Entries	Code																																																																																																											
<b>Ex d</b>																																																																																																												
1 x M20	1B																																																																																																											
1 x PG13.5	1P																																																																																																											
2 x M20	2B																																																																																																											
2 x PG13.5	2P																																																																																																											
<b>Ex de</b>																																																																																																												
3 x M20	3B																																																																																																											
Finish	Code																																																																																																											
Natural black	N																																																																																																											
Red	R																																																																																																											
Blue	B																																																																																																											
Yellow	Y																																																																																																											
Grey	G																																																																																																											
White	W																																																																																																											
Special	S*																																																																																																											

## General arrangement drawing (all dimensions in mm)

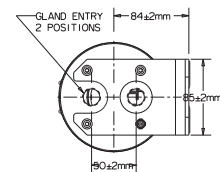
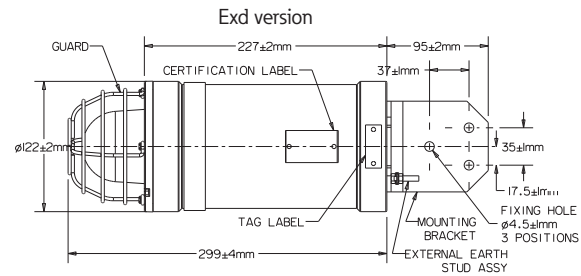
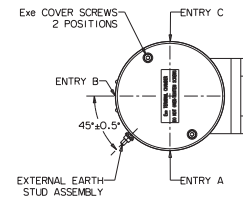
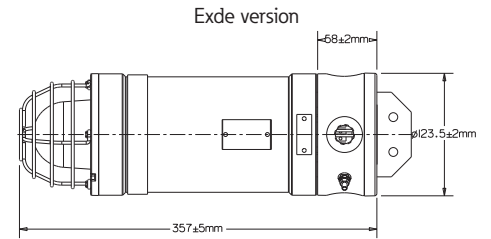

### Multiplying factor for coloured lens:

Red	Blue	Amber	Green	Yellow
0.15	0.12	0.51	0.49	0.86

The photometric data has been verified by BSI. A report is available if required.